

4–5NM+ Solar Marine Lantern

SL-C420

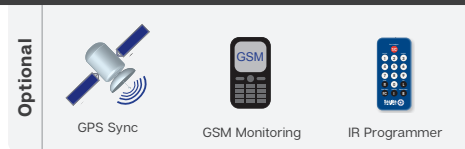

This equipment complies with requirements of the U.S. Coast Guard in 33 CFR part 66

The SL-C420 is a robust, completely self-contained 4–5NM+ Solar LED Marine Lantern which incorporates a 36 LED light source for even greater light intensity. The 3 & 4 hole bolt pattern base fits directly onto existing 200mm bolt pattern industry standard mounts for ease of installation.

The chassis of the SL-C420 is made from cast aluminium, with UV-stabilised rubber corners and gaskets providing a superior IP68 waterproof rating – the best in the industry.

Four (4) premium-grade solar modules are integrated into the assembly and mounted to collect sunlight at all angles.

The unit is capable of producing any of 256 IALA recommended flash characters – field-adjustable without the need for ancillary equipment.

The tough polycarbonate lens is specifically designed for use with LEDs and incorporates an environment-friendly bird spike – deterring unwelcome bird life. The lens design also ensures that vessel operators clearly see the light from above, when passing the AtoN.

GPS Synchronisation

For flash synchronisation of lanterns installed over longer ranges, a GPS module may be fitted.

When lanterns flash in synchronisation they can be clearly distinguished from other nav aids and confusing background lighting – ideal for rivers, marina entrances, channel marking and aquaculture.

Optional GSM Monitoring & Control System

The SL-C420 may also be fitted with GSM Cell-Phone Monitoring and Control – enabling users to access real-time diagnostics data and change lantern settings via cell-phone. The system can also be configured to send out alarm SMS text messages to designated cellular telephone numbers. Users can also have alarms and reports sent to designated email addresses.

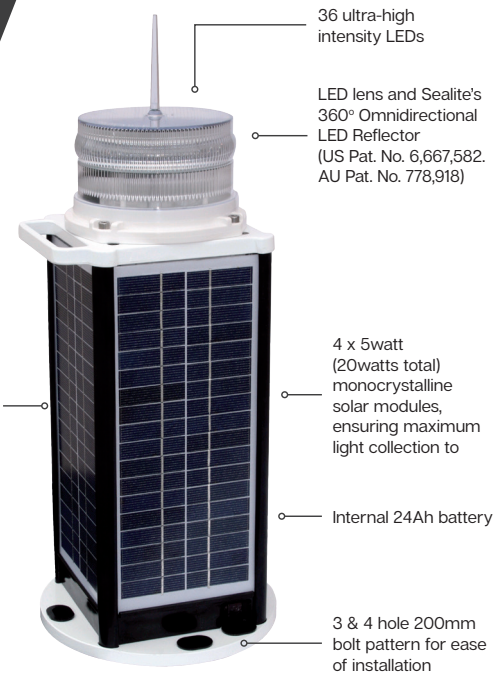

Cork, Ireland



Queensland, Australia



SL-C420's mounted on SL-B1250 Navigation Buoys, Pasig River, Manila, Philippines

The Sealite Advantage

- Simplicity of design ensures ease of maintenance in the field
- Heavy-duty aluminium construction
- All components are user-replaceable in the unlikely event of damage
- 200mm bolt pattern for immediate installation on existing structures
- User-replaceable battery
- Vertical light emissions to maintain visibility when passing adjacent to light

Photometric Output

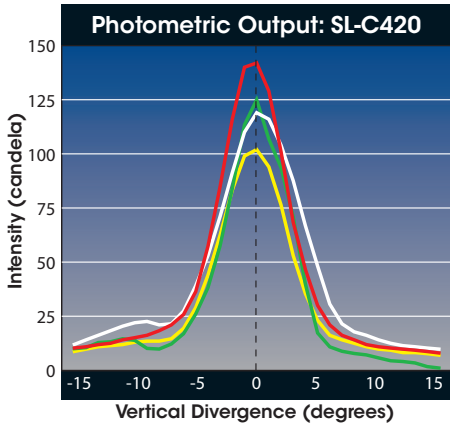

Colour	SL-C420
RED	142
GREEN	125
WHITE	119
YELLOW	102

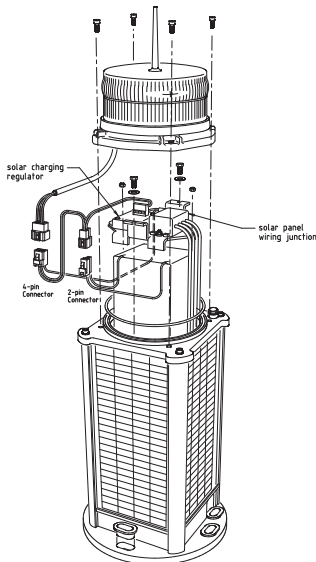

Convenient user-replaceable battery

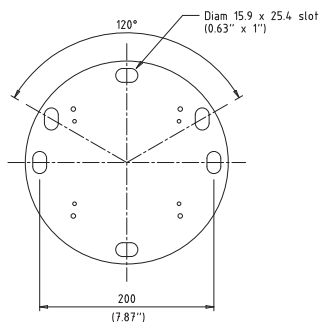
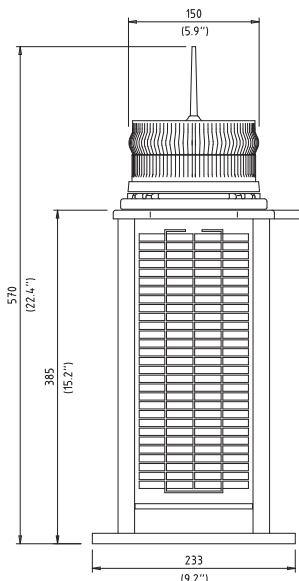

Technical Specifications *

SL-C420	
Light Characteristics	
Light Source	36 Ultra-high intensity LEDs
Available Colours	Red, Green, White, Yellow, Blue
Typical Maximum Intensity (cd) [†]	Red - 142 Green - 125 White - 119 Yellow - 102
Visible Range (NM)	AT @ 0.74: 4-5+ AT @ 0.85: 4.8-6.3+
Horizontal Output (degrees)	360
Vertical Divergence (degrees)	9
Reflector Type	Omnidirectional 360° LED Reflector (US Pat. No. 6,667,582. AU Pat. No. 778,918)
Available Flash Characteristics	Up to 310 IALA recommended (user adjustable)
Intensity Adjustments	Adjustable in 25% increments
LED Life Expectancy (hours)	>100,000
Electrical Characteristics	
Current Draw (mA)	Refer to Sealite Power Calculator
Circuit Protection	Integrated
Nominal Voltage (V)	12
Autonomy (days)	>15 (14 hour darkness, 12.5% duty cycle)
Temperature Range	-40 to 80°C
Solar Characteristics	
Solar Module Type	Monocrystalline
Output (watts)	20 (4 x 5watt)
Charging Regulation	Microprocessor controlled
Power Supply	
Battery Type	Gel SLA
Battery Capacity (Ah)	24
Nominal Voltage (V)	12
Physical Characteristics	
Body Material	Aluminium chassis with UV-stabilised rubber corners & gaskets. Polycarbonate composite moulded top and base
Lens Material	LEXAN® Polycarbonate – UV-stabilised
Lens Diameter (mm/inches)	150 / 5 ^{7/8}
Lens Design	External optics with interior flute design
Mounting	3 & 4 hole 200mm bolt pattern
Height (mm/inches)	570 / 22 ^{2/5}
Width (mm/inches)	233 / 9 ^{1/5}
Mass (kg/lbs)	13.9 / 30 ^{5/8}
Product Life Expectancy	Up to 12 years [^]
Certifications	
CE	EN61000-6-3:1997. EN61000-6-1:1997
IALA	Signal colours compliant to IALA E-200-1
Quality Assurance	ISO 9001:2015
Waterproof	IP68
Intellectual Property	
Patents	US Pat. No. 6,667,582. AU Pat. No. 778,918
Trademarks	SEALITE® is a registered trademark of Sealite Pty Ltd
Warranty *	3 years
Options Available	<ul style="list-style-type: none"> • GPS Synchronisation • GSM Monitoring & Control System • 50mm pole mount adapter plate

* Intensity setting subject to solar availability
 † Subject to standard terms and conditions
 * Specifications subject to change or variation without notice
 ^ Refer to the Sealite website under the warranty section



We believe technology improves navigation™



Sealite Pty Ltd
Australia
+61 (0)3 5977 6128

Sealite Asia Pte Ltd
Singapore
+65 6829 2243

Sealite United Kingdom Ltd
UK
+44 (0) 1502 588026

Sealite USA LLC
USA
+1 (603) 737 1311

